

STEP LIGHT-277V

WL-LED200F

WAC®



Fixture Type:

Catalog Number:

Project: _____

Location: _____

PRODUCT DESCRIPTION

With a sleek profile and no visible hardware, Endurance Step and Wall Lights are designed to seamlessly blend into any architectural environment. These luminaires deliver enhanced energy efficiency and optimized light output to effectively illuminate stairs, walls, and walkways with little to no glare.

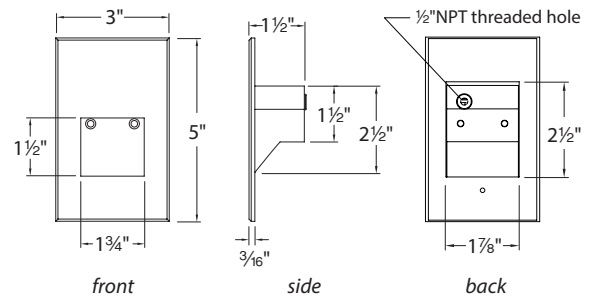

FEATURES

- Direct wiring, no driver needed
- Low profile, flush to wall aesthetics with no visible hardware
- IP66 rated, protected against high-pressure jets
- 54,000 hour rated life
- Balanced lighting, free of shadows with minimum glare

SPECIFICATIONS

- Construction:** Die-cast aluminum, or 316 marine grade cast stainless steel
- Power:** Direct wiring, no remote driver needed.
Input voltage: 277V 50/60Hz
- Light Source:** Integrated LED Module, CRI 90+
Optional color lenses. Total power consumption of 3.5W
- Mounting:** Fits into 2" x 4" J-Box with minimum inside dimensions of 3"L x 2"W x 2"H
Includes bracket for J-Box mount.
- Dimming:** 100-10% ELV
- Standards:** IP66, ETL & cETL Listed for wet locations
Title 24 JA8-2016 Compliant.

ORDER NUMBER

277V	Color Temperature	Lumens	Finish
WL-LED200 277V	30 White 3000K	65	BK Black on Aluminum
	AM Amber 610nm		BN* Brushed Nickel on Aluminum
	RD Red 640nm		BZ Bronze on Aluminum
	BL Blue 450nm		GH Graphite on Aluminum
			SS Stainless Steel
			WT White on Aluminum

*Brushed Nickel Finish is for interior use only



Example: **WL-LED200F-30-SS**

wacighting.com

Phone (800) 526.2588

Fax (800) 526.2585

Headquarters, East Manufacturing Facility

44 Harbor Park Drive

Port Washington, NY 11050

South East Manufacturing Facility

1600 Distribution Ct

Lithia Springs, GA 30122

Central Manufacturing Facility

1700 South J Elmer Freeway, Ste 100

Cedar Hill, TX 75104

West Manufacturing Facility

1750 S Archibald Ave

Ontario, CA 91761